

NRI ENCLAVE AT KHARAR (PB)

PROMOTERS
M/S RAINBOZ PROJECTS & DEVELOPMENTS
2505, SECTOR 35C, CHANDIGARH
TEL: 666627, MOBILE: 98140-67735

COPYRIGHT
This drawing and design is a copyright. It is loaned for the project mentioned above in the title of this sheet and is subject to recall at any stage. It shall not be lent, traced, copied, altered, reproduced or used in whole or in parts without the written permission of the proprietor.

GENERAL NOTES

AREA STATEMENT
TOTAL AREA OF LAND 22,082.50 sqyds
4.562 acre
1.847 hectares

TOTAL SALEABLE AREA 13,249.34 sqyds (60%)

RESIDENTIAL 12,018.22 sqyds (54.42%)
COMMERCIAL 1,063.41 sqyds (4.82%)
RESERVED SPACE 157.71 sqyds (0.75%)

AREA UNDER ROADS, PARKS & PUBLIC AMENITIES 8,833.16 sqyds (40%)

PARKS 1,288.89 sqyds (5.84%)
ROADS & OPEN SPACES 6,264.16 sqyds (28.37%)
WATER WORKS 253.33 sqyds (1.15%)
COMMUNITY CENTRE 975.00 sqyds (4.41%)
TOILET 51.80 sqyds (0.23%)

TOTAL NO. OF PLOTS 73
RESIDENTIAL 43
COMMERCIAL 30

TOTAL NO. OF DWELLING UNITS 129
@ 3 dwelling units per plot (3 X 43)

TOTAL POPULATION 645
@ 5 person per dwelling unit (5 X 129)

DENSITY OF DWELLING UNITS PER ACRE 28.28
(129 ÷ 4.562)

DENSITY OF POPULATION PER ACRE 141.38
(645 ÷ 4.562)

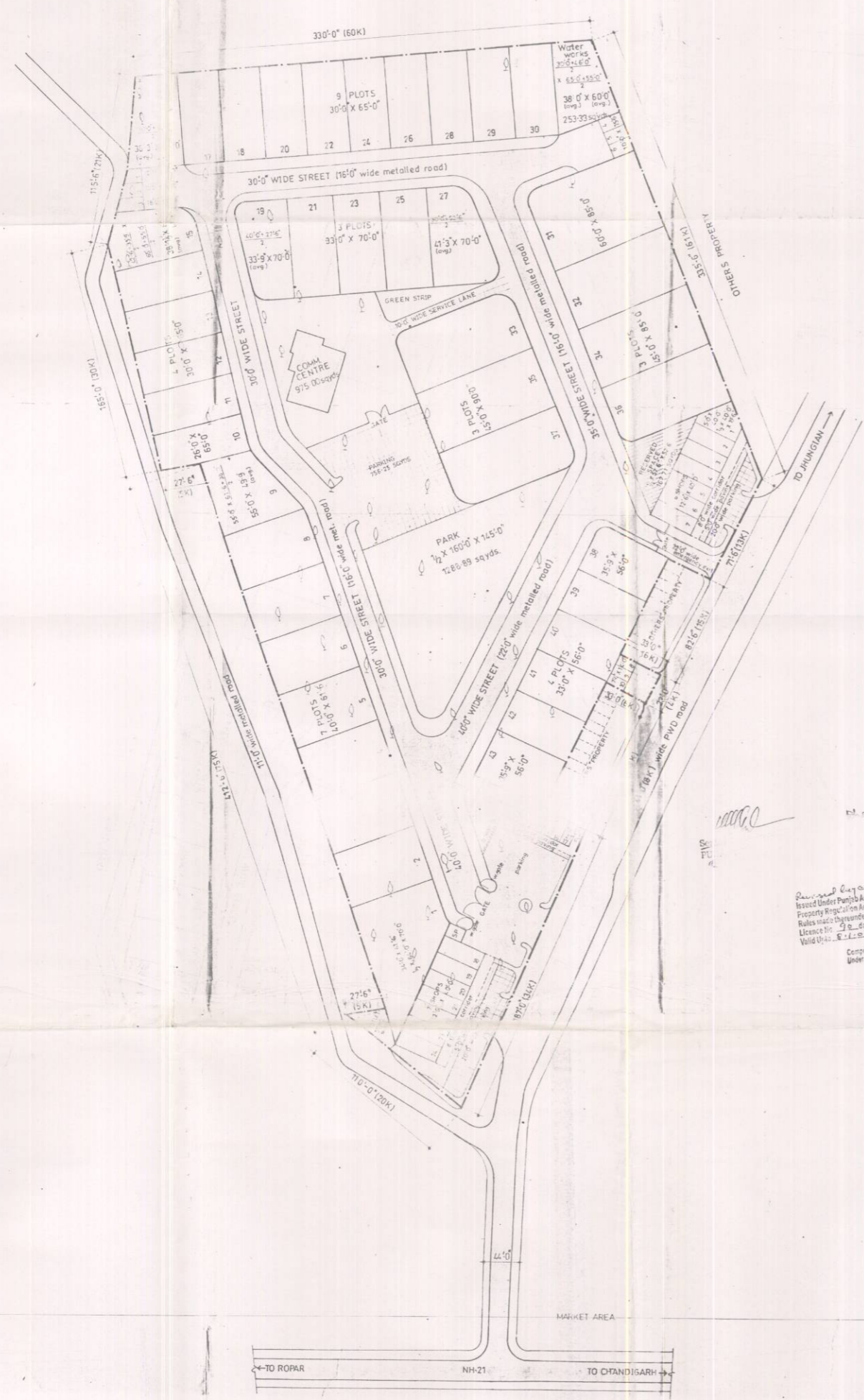

AREA STATEMENT									
S NO	CATEGORY	PLOT NO	QTY	SIZE	AREA OF A UNIT PLOT		TOTAL AREA OF ALL PLOTS IN A PARTICULAR BLOCK	REMARKS	
					SQFT	SQYDS			
1	2	3	4	5	6	7	8 (4 X 7)	9	
I	RESIDENTIAL	1	1	34'0" X 61'6" + 1/2 X 61'6" X 70'0"	4,331.00	481.22	481.22	SIZE & AREA REVISED	
		2 to 8	7	4'0" X 61'6"	2,460.00	273.33	1913.33	SIZES AREAS REVISED	
		9	1	55'0" X 49'9" (long)	2,736.25	304.03	304.03	SIZE & AREA REVISED	
		10	1	26'0" X 65'0"	1,690.00	187.78	187.78	SIZE & AREA REVISED	
		11 to 14, 17, 18, 20, 22, 24, 26, 28 to 30	13	30'0" X 65'0"	1,950.00	216.67	2,816.67		
		15	1	38'1 1/2" X 60'0"	2,287.50	254.17	254.17		
		16	1	36'3" X 65'0"	2,356.25	261.80	261.80	WATER WORKS SHIFTED	
		19	1	33'9" X 70'0"	2,362.50	262.50	262.50		
		21, 23, 25	3	33'0" X 70'0"	2,310.00	256.67	770.00		
		27	1	41'3" X 70'0"	2,887.50	320.83	320.83		
		31	1	60'0" X 85'0"	5,100.00	566.67	566.67	SHAPE, SIZE & AREA REVISED SLIGHTLY	
		32, 33, 36	3	45'0" X 85'0"	3,825.00	425.00	1,275.00		
		33, 35, 37	3	45'0" X 90'0"	4,050.00	450.00	1,350.00		
		39, 43	2	35'9" X 56'0"	2,002.00	222.44	444.89	SIZES & AREAS REVISED	
		39 to 42	4	33'0" X 56'0"	1,848.00	205.33	821.33	SIZES & AREAS REVISED	
		TOTAL	43				12,018.22 sqyds		
DEDUCTION ON ACCOUNT OF AREA OF ROUNDED EDGES OF CORNER PLOTS (16'6" radius curvature of the boundary wall) 12 X 1-00 sqyds 12.00									
NET RESIDENTIAL AREA							12,018.22 sqyds		
II	COMMERCIAL	1	1	10'0" X 12'0"	120.00	13.33	13.33		
	Service booths	2	1	10'0" X 15'0"	150.00	16.67	16.67		
		3	1	10'0" X 18'0"	180.00	20.00	20.00		
		4 to 6	3	10'0" X 15'6"	155.00	17.22	51.67		
		7	1	5'0" X 10'0" + 1/2 X 10'0" X 19'6"	580.00	65.55	65.55		
		TOTAL	30				1,063.41 sqyds		

Approved layout plan
Issued Under Punjab Apartment &
Property Regulation Act, 1956 &
Rules made thereunder 1956.
Licence No. 92 dated 21.10.02
Valid Upto. 6.11.2005
Competent Authority
Under PAPP Act, 1995
S.A.S. Nagar.

DATE	PARTICULARS
17.09.2003	ROADS ALONG PERIMETER OF PLOT NO. 31 & 32 RE-ALLIGNED TO 30 FEET WIDE TO BRIDGE OVER PLOTS. SIZES OF PLOTS NOS. 110, 111, 112, 113, 114, 115, 116, 117, 118, 119, 120, 121, 122, 123, 124, 125, 126, 127, 128, 129, 130, 131, 132, 133, 134, 135, 136, 137, 138, 139, 140, 141, 142, 143, 144, 145, 146, 147, 148, 149, 150, 151, 152, 153, 154, 155, 156, 157, 158, 159, 160, 161, 162, 163, 164, 165, 166, 167, 168, 169, 170, 171, 172, 173, 174, 175, 176, 177, 178, 179, 180, 181, 182, 183, 184, 185, 186, 187, 188, 189, 190, 191, 192, 193, 194, 195, 196, 197, 198, 199, 200, 201, 202, 203, 204, 205, 206, 207, 208, 209, 210, 211, 212, 213, 214, 215, 216, 217, 218, 219, 220, 221, 222, 223, 224, 225, 226, 227, 228, 229, 230, 231, 232, 233, 234, 235, 236, 237, 238, 239, 240, 241, 242, 243, 244, 245, 246, 247, 248, 249, 250, 251, 252, 253, 254, 255, 256, 257, 258, 259, 260, 261, 262, 263, 264, 265, 266, 267, 268, 269, 270, 271, 272, 273, 274, 275, 276, 277, 278, 279, 280, 281, 282, 283, 284, 285, 286, 287, 288, 289, 290, 291, 292, 293, 294, 295, 296, 297, 298, 299, 300, 301, 302, 303, 304, 305, 306, 307, 308, 309, 310, 311, 312, 313, 314, 315, 316, 317, 318, 319, 320, 321, 322, 323, 324, 325, 326, 327, 328, 329, 330, 331, 332, 333, 334, 335, 336, 337, 338, 339, 340, 341, 342, 343, 344, 345, 346, 347, 348, 349, 350, 351, 352, 353, 354, 355, 356, 357, 358, 359, 360, 361, 362, 363, 364, 365, 366, 367, 368, 369, 370, 371, 372, 373, 374, 375, 376, 377, 378, 379, 380, 381, 382, 383, 384, 385, 386, 387, 388, 389, 390, 391, 392, 393, 394, 395, 396, 397, 398, 399, 400, 401, 402, 403, 404, 405, 406, 407, 408, 409, 410, 411, 412, 413, 414, 415, 416, 417, 418, 419, 420, 421, 422, 423, 424, 425, 426, 427, 428, 429, 430, 431, 432, 433, 434, 435, 436, 437, 438, 439, 440, 441, 442, 443, 444, 445, 446, 447, 448, 449, 450, 451, 452, 453, 454, 455, 456, 457, 458, 459, 460, 461, 462, 463, 464, 465, 466, 467, 468, 469, 470, 471, 472, 473, 474, 475, 476, 477, 478, 479, 480, 481, 482, 483, 484, 485, 486, 487, 488, 489, 490, 491, 492, 493, 494, 495, 496, 497, 498, 499, 500, 501, 502, 503, 504, 505, 506, 507, 508, 509, 510, 511, 512, 513, 514, 515, 516, 517, 518, 519, 520, 521, 522, 523, 524, 525, 526, 527, 528, 529, 530, 531, 532, 533, 534, 535, 536, 537, 538, 539, 540, 541, 542, 543, 544, 545, 546, 547, 548, 549, 550, 551, 552, 553, 554, 555, 556, 557, 558, 559, 560, 561, 562, 563, 564, 565, 566, 567, 568, 569, 570, 571, 572, 573, 574, 575, 576, 577, 578, 579, 580, 581, 582, 583, 584, 585, 586, 587, 588, 589, 590, 591, 592, 593, 594, 595, 596, 597, 598, 599, 600, 601, 602, 603, 604, 605, 606, 607, 608, 609, 610, 611, 612, 613, 614, 615, 616, 617, 618, 619, 620, 621, 622, 623, 624, 625, 626, 627, 628, 629, 630, 631, 632, 633, 634, 635, 636, 637, 638, 639, 640, 641, 642, 643, 644, 645, 646, 647, 648, 649, 650, 651, 652, 653, 654, 655, 656, 657, 658, 659, 660, 661, 662, 663, 664, 665, 666, 667, 668, 669, 670, 671, 672, 673, 674, 675, 676, 677, 678, 679, 680, 681, 682, 683, 684, 685, 686, 687, 688, 689, 690, 691, 692, 693, 694, 695, 696, 697, 698, 699, 700, 701, 702, 703, 704, 705, 706, 707, 708, 709, 710, 711, 712, 713, 714, 715, 716, 717, 718, 719, 720, 721, 722, 723, 724, 725, 726, 727, 728, 729, 730, 731, 732, 733, 734, 735, 736, 737, 738, 739, 740, 741, 742, 743, 744, 745, 746, 747, 748, 749, 750, 751, 752, 753, 754, 755, 756, 757, 758, 759, 760, 761, 762, 763, 764, 765, 766, 767, 768, 769, 770, 771, 772, 773, 774, 775, 776, 777, 778, 779, 780, 781, 782, 783, 784, 785, 786, 787, 788, 789, 790, 791, 792, 793, 794, 795, 796, 797, 798, 799, 800, 801, 802, 803, 804, 805, 806, 807, 808, 809, 810, 811, 812, 813, 814, 815, 816, 817, 818, 819, 820, 821, 822, 823, 824, 825, 826, 827, 828, 829, 830, 831, 832, 833, 834, 835, 836, 837, 838, 839, 840, 841, 842, 843, 844, 845, 846, 847, 848, 849, 850, 851, 852, 853, 854, 855, 856, 857, 858, 859, 860, 861, 862, 863, 864, 865, 866, 867, 868, 869, 870, 871, 872, 873, 874, 875, 876, 877, 878, 879, 880, 881, 882, 883, 884, 885, 886, 887, 888, 889, 890, 891, 892, 893, 894, 895, 896, 897, 898, 899, 900, 901, 902, 903, 904, 905, 906, 907, 908, 909, 910, 911, 912, 913, 914, 915, 916, 917, 918, 919, 920, 921, 922, 923, 924, 925, 926, 927, 928, 929, 930, 931, 932, 933, 934, 935, 936, 937, 938, 939, 940, 941, 942, 943, 944, 945, 946, 947, 948, 949, 950, 951, 952, 953, 954, 955, 956, 957, 958, 959, 960, 961, 962, 963, 964, 965, 966, 967, 968, 969, 970, 971, 972, 973, 974, 975, 976, 977, 978, 979, 980, 981, 982, 983, 984, 985, 986, 987, 988, 989, 990, 991, 992, 993, 994, 995, 996, 997, 998, 999, 1000

CLIENT:

ARCHITECT:

KANT & ASSOCIATES
CONSULTING ARCHITECTS, INTERIOR DESIGNERS, URBAN DESIGNERS, LANDSCAPE ARCHITECTS, ENVIRONMENT DESIGNERS AND PLANNERS

kant & associates
1149, SECTOR 44 B, CHANDIGARH-160047
TEL: 603719
FAX: 0172 665525

CORPORATION DRAWING - REVISED
NUMBERING PLAN - THIS DRAWING SUPERCEDES DRG NO. CD-021R - KA-0716 DATED 24.09.2001

SCALE: 1" = 40'0"

PROJECT	DRAWING NO.
ka cd	02
0716 COL.BAATH	R-1
COLONY KHARAR	
DRAWN CHEL	
CHECKED S KANT	

DATE: 09/09/2003