

PROPOSED HOUSING LAYOUT OF SAVITRY TOWERS FOR N.K.SHARMA ENTERPRISES PVT. LTD. AT V.I.P. ROAD, LOHGARH, ZIRAKPUR

NOTES:

AREA STATEMENT

FOUR BEDROOM UNIT:
COVERED AREA OF D.U.=1937.8 SQ.FT.
TOTAL NO. OF D.U.=8
TOTAL COVERED AREA =8X1937.8=15502.80SQ.FT.

THREE BEDROOM UNIT:
COVERED AREA OF D.U.=1499.59 SQ.FT.
NO. OF D.U. IN ONE CLUSTER=6
NO. OF D.U. ON GROUND IN ONE CLUSTER=1
TOTAL NO. OF D.U. ON GROUND = 8
NO. OF D.U. ON FIRST, SECOND,THIRD,FOURTH FLOOR IN ONE CLUSTER=(3X4)=12
TOTAL NO OF D.U.=[12X8=96]+8=104
TOTAL COVERED AREA=104X1499.59 =155957.36 SQ.FT.

TWO BEDROOM UNIT:
COVERED AREA OF D.U.=1143.56 SQ.FT.
NO OF D.U ON GROUND=10
NO OF D.U. ON FIRST, SECOND,THIRD,FOURTH,FIFTH,SIXTH FLOOR=10X6=60
TOTAL NO OF D.U.=70
TOTAL COVERED AREA=70X1143.56=80049.20SQ.FT.

E.W.S. (BLOCK III):
COVERED AREA OF D.U.=395.56 SQ.FT.
NO OF D.U. ON GROUND=4
NO OF D.U. ON FIRST AND SECOND FLOOR=3
TOTAL NO OF D.U.=12
TOTAL COVERED AREA=12X395.56=4746.72SQ.FT.

TOTAL RESIDENTIAL UNITS=8+104+24+70+12=218

COMMERCIAL (SHOPS) [SINGLE STOREY]
COVERED AREA ON GROUND=2210 SQ.FT. ✓

PENT HOUSES:
COVERED AREA OF D.U.=2153.95 SQ.FT.
NO OF D.U.=24
TOTAL COVERED AREA=24X2153.95 =51694.80 SQ.FT.

PLOT AREA=15821.561 SQ.FT.
GROUND COVERAGE =42727.36 SQ.FT. (27%)
PERMISSIBLE F.A.R.=200%
PROPOSED F.A.R.=196%

TOTAL PLOT AREA- 15821.561 SQ.FT.

GROUND COVERAGE UNDER BUILDINGS		
A) BLOCK I	42705.12 SQ.FT.	
B) BLOCK II	15142.50 SQ.FT.	
C) BLOCK III	1643.5405 SQ.FT.	
DIAREA UNDER SCHOOL	8717.68 SQ.FT.	5.51%
TOTAL	68206.845 SQ.FT.	43.11%

AREA UNDER METALLED ROAD	44979.11 SQ.FT.	28.41%
AREA UNDER SHOPS	2210 SQ.FT.	1.39%
AREA UNDER PARKING	27296 SQ.FT.	17.25%
AREA UNDER ORGANISED GREEN PARK	9966 SQ.FT.	6.30%
OTHER GREEN AREAS	4957.66 SQ.FT.	3.13%
AREA UNDER S.T.P.	600 SQ.FT.	0.38%

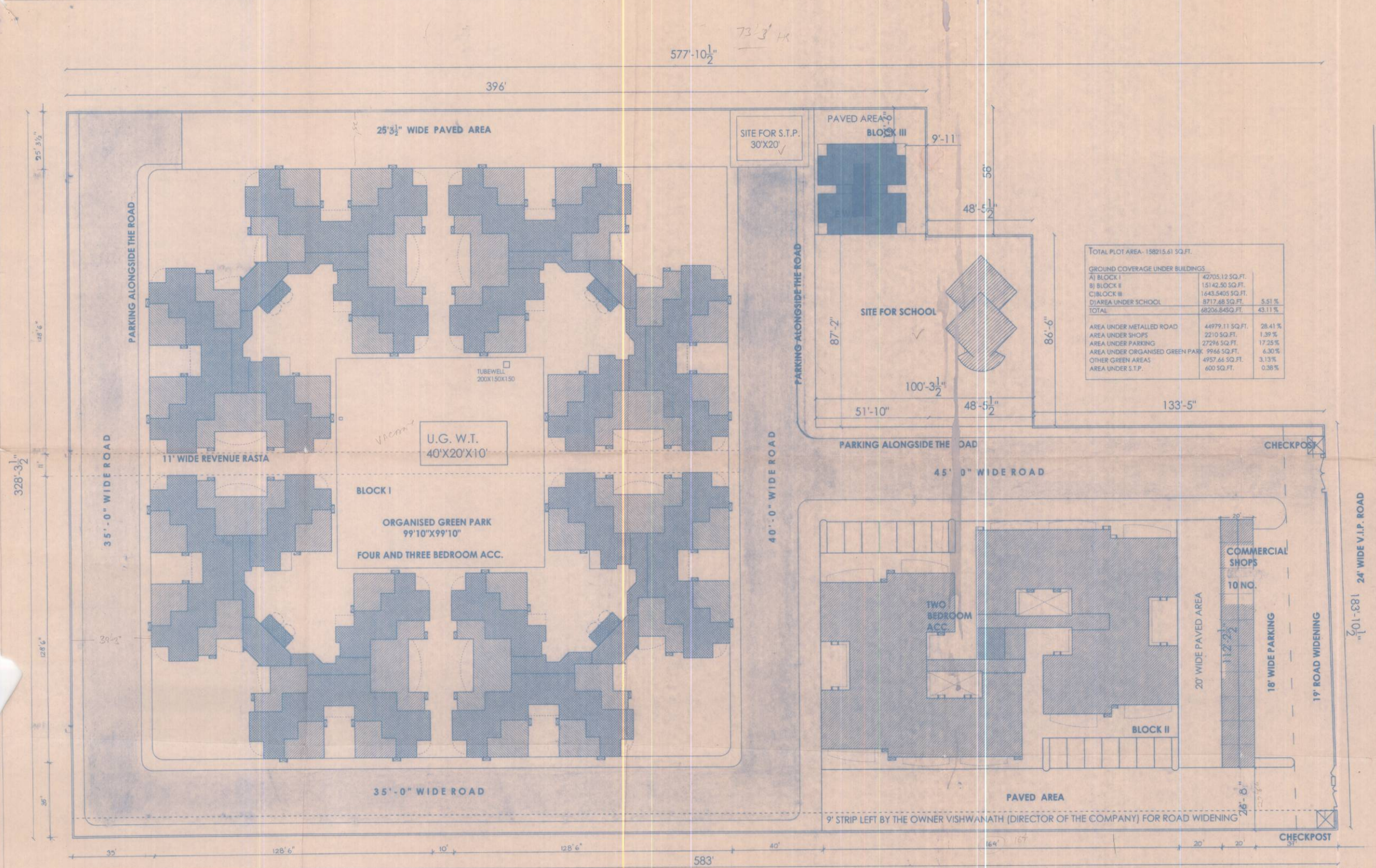

DWG. TITLE
SITE PLAN, ROAD NETWORK.

DATED: 02/08/2005

DWG. NO. R-01 SCALE: 1"=1/20"

DEALT BY: SHIVANI CHECKED BY:

OWNER'S SIGNATURE

ARCHITECT'S SIGNATURE

CREATIVE CONSORTIUM ARCHITECTS, PLANNERS, VALUERS AND INTERIOR DESIGNERS

S.C.O- 56, SWASTI, VIHAR, M.D.C. PKL

125, SECTOR - 4, PANCHKULA

PHONE: 2574057, FAX: 0172-2585375

DELHI OFF: 409, 18/12, W.E.A., KAROL BAGH, NEW DELHI

PHONE: 011-25754812

SHIMLA OFF: HOTEL CAMBERMERE COMPLEX, THE MALL SHIMLA.

PHONE: 0177-2214333

PROJ. NO.- CC/PH/01/2K5/NC/177

Project approved under P.B. apartment of Property Regulation Act 1995 License No. LDC-HBUD/NO.13 dated 19-8-2005 valid up to 18-8-2008.

Competent Authority
Senior Town Planner
S.A.S. Nagar