

AREA STATEMENT

PLOT AREA	2470 ACERS
PERMISSIBLE GR. COVG 40%	44783.341 SQ. FT
PERMISSIBLE FAR 1:1.76	188838.617 SQ. FT
PROPOSED GROUND COVERAGE	
CINEMA BLOCK-B	15727.213 SQ. FT
BLOCK-A	8181.483 SQ. FT
BLOCK-C	14471.523 SQ. FT
TOTAL	38380.219 SQ. FT
PROPOSED FAR	
BLOCK-A	15727.213
BLOCK-B	8181.483
BLOCK-C	14471.523
TOTAL	38380.219
MUMMITY & MACHINE ROOM AREA	
BLOCK-A	889.024
BLOCK-B	889.024
BLOCK-C	889.024
TOTAL	2667.072
NET FAR ACHIEVED	41047.291
PARKING AREA CALCULATION	
REQUIRED PARKING FOR CINEMA @ 2500 PER 100 SQM. + 30% AREA OF CINEMA HALL	
TOTAL NO OF ECS REQU. FOR CINEMA	6091.802
REQUIRED PARKING FOR COMMERCIAL @ 2500 PER 100 SQM. (BLOCK-A & BLOCK-C)	
TOTAL PARKING REQU.	103.35
PROPOSED PARKING	107.00
MECHANICAL	2.60
TOTAL ECS PROPOSED	112.60

1A	44.50	X	48.50	=	2158.25	SQ. FT
1	53.25	X	37.63	=	2003.83	SQ. FT
2	61.50	X	90.00	=	5535.00	SQ. FT
3	75.75	X	68.25	=	5270.06	SQ. FT
4	105.50	X	54.50	=	5769.25	SQ. FT
5	80.00	X	116.50	=	9320.00	SQ. FT
6	116.00	X	16.00	=	1856.00	SQ. FT
7	36.50	X	19.25	=	702.31	SQ. FT
8	27.88	X	36.00	=	1003.50	SQ. FT
TOTAL					26670.80	SQ. FT
TOTAL ECS @ 23/ECS					1161.34	ECS

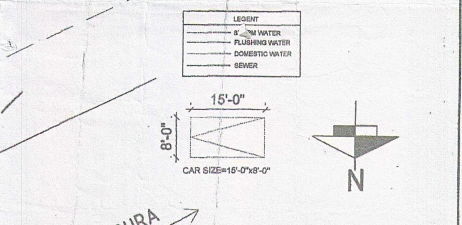
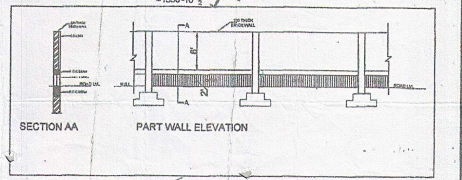

PROJECT TITLE
 PROPOSED COMMERCIAL COMPLEX FOR PRIME PREMIUM STORE AT NH-64 AT VILLAGE, PEHAR KALAN, AND VILLAGE NIAMATPUR, TEHSIL - RAJUPURA DIST, PATIALA, PUNJAB

SCALE NTS
DATE OCT. 2014
CHECKED VG
ARCHITECT Design Axis architects

ARCHITECT'S SIGN.
 For M/s. Prime Premium Stores
 Partner

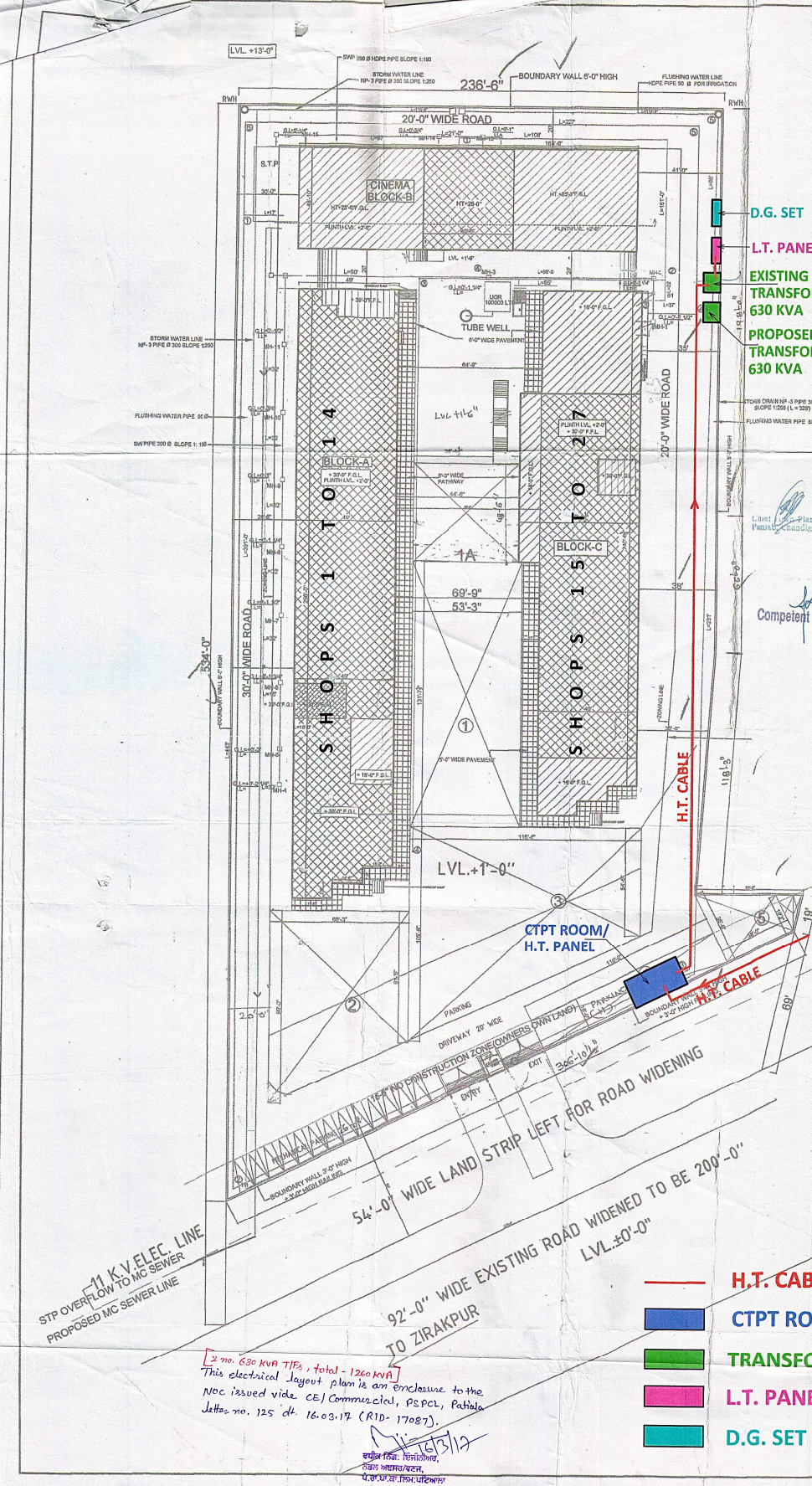

- H.T. CABLE
- CPT ROOM/H.T. PANEL
- TRANSFORMER
- L.T. PANEL
- D.G. SET

2 no. 630 KVA TFS, total - 1260 KVA
 This electrical layout plan is an enclosure to the Noc issued vide CE/Commercial, PSpcl, Patiala Jett no. 125 dt. 16.03.17 (RID- 17087).

(Signature)
 4/5. 6/2014
 Dy. Chief Engineer/DS Circle
 P.S.P.C.L., Patiala.

4/5. *(Signature)*
 Dy. Chief Engineer/DS Circle
 P.S.P.C.L., Patiala.

4/5. *(Signature)*
 Addl. Substanning Engineer
 Powercom (C) Divn Rajpura
 For M/s. Prime Premium Stores
 Authorizing Partner