

# Chandigarh Enclave Residential colony at N.A.C. ZIRAKPUR ( Punjab)

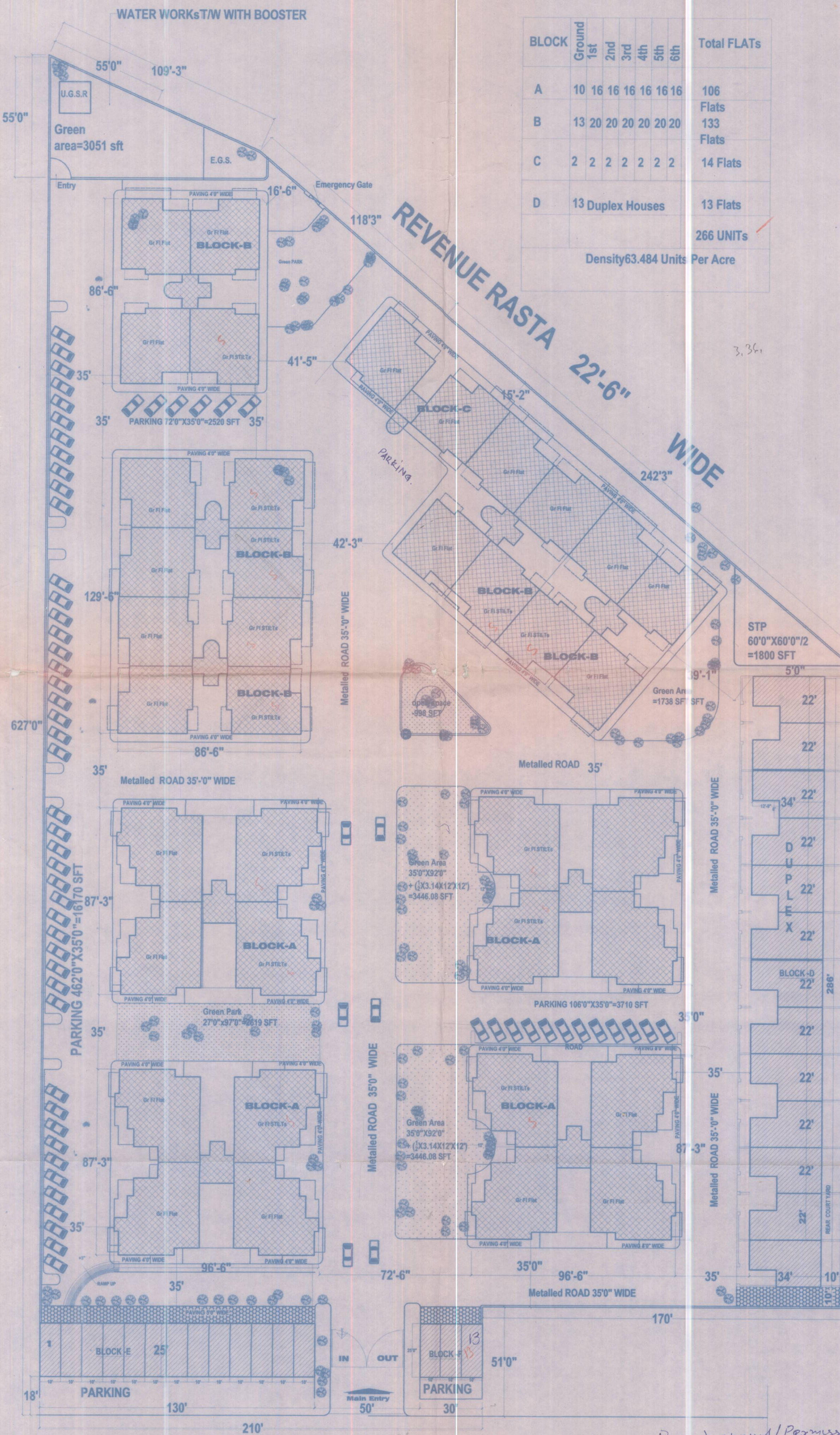

BLOCK	Ground	1st	2nd	3rd	4th	5th	6th	Total FLATS
A	10	16	16	16	16	16	16	106 Flats
B	13	20	20	20	20	20	20	133 Flats
C	2	2	2	2	2	2	2	14 Flats
D	13 Duplex Houses							13 Flats
								266 UNITS
Density 63.484 Units Per Acre								

## REVISED PLAN FOR CHANDIGARH ENCLAVE RESIDENTIAL COLONY AT N.A.C. ZIRAKPUR

**PROMOTERS**  
**CHANDIGARH COLONIZERS**  
**PRIVATE LIMITED**  
**SCO-18**  
**SEC-20**  
**CHANDIGARH**

Total Area in Scheme = 20305 Sq Yds (182745 SFT)  
= 4.19 Acres  
= 1.69 Hectares

TOTAL COVERED AREA  
= (41475.93+59357.29+49279.79+49279.79+49279.79+49279.79+49279.79)  
= 3,51,221.75 SFT  
COVERED FAR=1.922  
PER F.A.R.— 2.00  
TOTAL COVERED AREA for Scurtiny  
= 6'677.79 + 59357.29 + 49279.79 + 49279.79 + 49279.79 + 49279.79  
+ Momty Area=3928.40  
= 3,71,362.43 SFT (Including ship area = 8000 sft Res. = 363,362.43 X 1.25 = 454,203.04  
271,362.43 - 8000 = 3,63,362.43 sft = 8000 X 2.50 = 20,000  
Commercial Area=8000 SFT (4.377% of Plot Area) sft = 8000 X 2.50 = 20,000  
Total = 4,74,203.04

PER COVERED AREA ON Ground FI=73098 SFT  
COVERED AREA ON Ground FI=61677.79 SFT i.e. 33.75 %

COVERED AREA ON Gr FI(STILTS & FLAT)=  
Block A(TOTAL UNITS)4 =5861.64 X4=23446.56 SFT  
Block B(TOTAL UNITS)5 =4678.31X5=23391.55 SFT  
BLOCK C=2441.68 SFT  
BLOCK D=8398 SFT  
BLOCK E F=4000 SFT  
=61677.79 SFT GROUND COVERAGE = 33.75%

COVERED AREA ON Gr FI(UNDER FLAT)=  
Block A(TOTAL UNITS)4 = (3060.9X2)+(4461.27X2)=6121.8+8922.54=15044.34 SFT  
Block B(TOTAL UNITS)3 = (2449.85X2)+(3664.08X3)=4899.7+10992.24=15891.94 SFT  
BLOCK C=2441.68 SFT  
BLOCK D=8398 SFT  
BLOCK E F=4000 SFT  
=45475.93 SFT

COVERED AREA ON Gr FI(UNDER STILTS)=  
61677.79-45175.93=16501.86 SFT

COVERED AREA ON First FI=  
Block A(TOTAL UNITS)4 =5861.64 X4=23446.56 SFT  
Block B(TOTAL UNITS)5 =4678.31X5=23391.55 SFT  
BLOCK C=2441.68 SFT  
BLOCK D=6077.5 SFT  
BLOCK E F=4000 SFT  
=59357.29 SFT

COVERED AREA ON Second Floor =  
Block A(TOTAL UNITS)4 =5861.64 X4=23446.56 SFT  
Block B(TOTAL UNITS)5 =4678.31X5=23391.55 SFT  
BLOCK C = 2441.68 SFT  
=49279.79 SFT

COVERED AREA ON 3rd Floor =  
Block A(TOTAL UNITS)4 =5861.64 X4=23446.56 SFT  
Block B(TOTAL UNITS)5 =4678.31X5=23391.55 SFT  
BLOCK C = 2441.68 SFT  
=49279.79 SFT

COVERED AREA ON 4th Floor=49279.79 SFT  
COVERED AREA ON 5th Floor=49279.79 SFT  
COVERED AREA ON 6th Floor=49279.79 SFT

COVERED AREA ON Momty=A+B+C+D=1121.16+1164.15+209.58+1433.51=3928.40 SFT  
COVERED AREA ON MomtyA=280.29X4=1121.16 SFT  
COVERED AREA ON MomtyB=232.83X5=1164.15 SFT  
COVERED AREA ON MomtyC=209.58+209.58 SFT

GREEN AREA =3446.08+3446.08+1738+998+2619=12247.16 i.e 6.7 % of Site  
COVERED PARKING(UNDER STILTS)=16501.56 i.e 9 % of Site  
OPEN PARKING=3710+2520+16170=22400 SFT i.e 12.26 % of Site

## Title-SITE PLAN

SCALE=1/32"=1'0"

DRG NO- CE/SUB 01

Owner

Architect



North

**RAJNI & ASSOCIATES**  
**ARCHITECTS, PLANNERS**  
**# 394 Sector-15**  
**CHANDIGARH**

Project approval/Permission  
granted under DAPR Act. 95  
License No. 11 date 4-8-2005  
Valid up to 3-8-2008  
Dharambik  
Competent Authority-cum-  
Senior Town Planner  
S.A.S. Nagar  
Consent Authority  
Senior Town Planner  
S.A.S. Nagar