

**PROPOSED
DEFENCE ENCLAVE
AT
LOHGARH
NAC ZIRAKPUR
(PB.)**

PROMOTERS
N. K. SHARMA ENTERPRISES PVT. LTD.
ZIRAKPUR
PHONE NO. 2255 2486
95.701 37510

COPYRIGHT
This drawing and design is a copyright. It is loaned for the project mentioned above in the title of this sheet and is subject to recall at any stage. It shall not be lent, traced, copied, altered, reproduced or used in whole or in parts without the written permission of the proprietor.

GENERAL NOTES
Area Statement

| | |
|--|--------------------------------|
| TOTAL AREA OF LAND (AS PER REVENUE RECORD) (184 K-114) | 50850.25 sqyds 10.506 acres |
| TOTAL SALEABLE AREA | 30507.47 sqyds 5999% |
| a Residential | 27950.15 sqyd (54.59%) |
| b Commercial | 2548.32 sqyd (5.00%) |
| AREA UNDER PARKS, RESERVED + 20342.76 sqyds | |
| GREEN SPACE, PUBLIC AMENITIES (40.01%) | |
| Roads & Parking | |
| Parks | 3460.54 sqyd (6.80%) |
| Community centre-1133.33 | (2.21%) |
| School (Nursery) | 1196.60 (2.39%) |
| Water works & elec. substation | 525.00 sqyd (1.04%) |
| Reserved green space | 529.76 sqyd (1.04%) |
| Roads & parking | 1349.67 sqyd (26.39%) |
| TOTAL NO. OF PLOTS | 164 |
| RESIDENTIAL | 126 |
| COMMERCIAL | 40 |
| TOTAL NO. OF DWELLING UNITS | 372 |
| RESIDENTIAL | 1074 X 33 |
| COMMERCIAL | 1074 X 33 |
| TOTAL POPULATION | 1860 |
| @ 5 person per dwelling unit | (1372 X 5) |
| DENSITY OF POPULATION | 177.04 |
| (1850-10506) | (1-200 TP NORM) |
| DWELLING UNITS/ACRE | 35.40 |
| (1372 + 10506) | (1-40 TP NORM) |

This drawing supersedes DRG NO CD-02/186-07 dated 24/07/2001

REVISIONS

| S NO | DATE | PARTICULARS |
|------|------------|---|
| 1 | 23.08.2001 | THE AREA UNDER PROPOSED ENCLAVE WITH STATE 2000 FT. PERMITS THE VARIOUS PROPOSED SCHEMES OF PLOTS |
| 2 | 23.08.2001 | THE AREA UNDER PROPOSED ENCLAVE WITH STATE 2000 FT. PERMITS THE VARIOUS PROPOSED SCHEMES OF PLOTS |
| 3 | 23.08.2001 | THE AREA UNDER PROPOSED ENCLAVE WITH STATE 2000 FT. PERMITS THE VARIOUS PROPOSED SCHEMES OF PLOTS |
| 4 | 23.08.2001 | THE AREA UNDER PROPOSED ENCLAVE WITH STATE 2000 FT. PERMITS THE VARIOUS PROPOSED SCHEMES OF PLOTS |
| 5 | 23.08.2001 | THE AREA UNDER PROPOSED ENCLAVE WITH STATE 2000 FT. PERMITS THE VARIOUS PROPOSED SCHEMES OF PLOTS |
| 6 | 23.08.2001 | THE AREA UNDER PROPOSED ENCLAVE WITH STATE 2000 FT. PERMITS THE VARIOUS PROPOSED SCHEMES OF PLOTS |

CLIENT
N. K. SHARMA ENTERPRISES PVT. LTD.

ARCHITECT
KANT & ASSOCIATES

kant & associates
118, SECTOR 44B, CHANDIGARH-160047
TEL: 633140
FAX: 0172 865525

consulting architects interior designers
urban designers landscape architects
environment designers and planners.

CORPORATION DRAWING

| | | | | | |
|---------|--------|-------|-------|---------|------------|
| CONCEPT | DESIGN | DEALT | DRAWN | CHECKED | DATE |
| S KANT | S KANT | RAMAN | RAMAN | S KANT | 03/09/2001 |

| SNO | CATG | PLOT NO. | QTY | SIZE | AREA | | TOTAL AREA OF ALL PLOTS IN PARTICULAR BLOCK (LX7) |
|---|------|----------|---------------|---------------|---------------|---------|---|
| | | | | | SQ. FT. | SQ. YDS | |
| 1 | 2 | 3 | 4 | 5 | 6 | 7 | 8 |
| RESIDENTIAL | | | | | | | |
| BLOCK A | | | | | | | |
| 1 | 2 | 1 TO 13 | 161025 | 22 | 55'0" X 75'0" | 415312 | 49679 |
| 2 | 14 | 1 | 32'0" X 75'0" | 243750 | 27883 | 510000 | 57083 |
| 3 | 15 | 2 | 31'0" X 75'0" | 232500 | 27133 | 51667 | 56767 |
| 4 | 16 | 7 | 27'0" X 75'0" | 202500 | 23400 | 43600 | 46900 |
| 5 | 17 | 10 | 30'0" X 72'0" | 216000 | 24900 | 24900 | 24900 |
| 6 | 18 | 6 | 30'0" X 58'0" | 204000 | 23467 | 136000 | 136000 |
| 7 | 19 | 4 | 33'0" X 68'0" | 226500 | 26185 | 25185 | 25185 |
| 8 | 20 | 8 | 30'0" X 75'0" | 180000 | 20800 | 160000 | 160000 |
| TOTAL | | | | | | | |
| BLOCK B | | | | | | | |
| 1 | 21 | 17 | 2 | 80'0" X 43'0" | 348000 | 38657 | 73333 |
| 2 | 22 | 5 | 42'0" X 80'0" | 336000 | 37333 | 185567 | 185567 |
| 3 | 23 | 1 | 28'0" X 80'0" | 140825 | 16625 | 15625 | 15625 |
| 4 | 24 | 8 | 27'0" X 50'0" | 135000 | 15600 | 105000 | 105000 |
| 5 | 25 | 1 | 25'0" X 50'0" | 125000 | 14375 | 14236 | 14236 |
| 6 | 26 | 1 | 47'0" X 58'0" | 321300 | 35700 | 35700 | 35700 |
| 7 | 27 | 1 | 30'0" X 68'0" | 204000 | 23467 | 22567 | 22567 |
| 8 | 28 | 1 | 23'0" X 58'0" | 134100 | 15467 | 15467 | 15467 |
| 9 | 29 | 2 | 32'0" X 71'0" | 223725 | 25819 | 51633 | 51633 |
| 10 | 30 | 7 | 20'0" X 71'0" | 214500 | 23833 | 155833 | 155833 |
| 11 | 31 | 2 | 58'0" X 29'0" | 172575 | 19175 | 76700 | 76700 |
| 12 | 32 | 25 | 27'0" X 55'0" | 157500 | 17550 | 453000 | 453000 |
| 13 | 33 | 2 | 60'0" X 33'0" | 198750 | 22883 | 44567 | 44567 |
| 14 | 34 | 8 | 30'0" X 60'0" | 180000 | 20800 | 160000 | 160000 |
| TOTAL | | | | | | | |
| COMMERCIAL | | | | | | | |
| 1 | 35 | 1,9 | 2 | 25'0" X 75'0" | 191250 | 21250 | 42500 |
| 2 | 36 | 7 | 18'0" X 75'0" | 135000 | 15000 | 105000 | 105000 |
| 3 | 37 | 10 | 10'0" X 30'0" | 30000 | 3333 | 33333 | 33333 |
| 4 | 38 | 11 | 15'0" X 30'0" | 45000 | 5167 | 5167 | 5167 |
| 5 | 39 | 1 | 15'0" X 30'0" | 45000 | 5167 | 5167 | 5167 |
| 6 | 40 | 2 | 10'0" X 30'0" | 30000 | 3333 | 63333 | 63333 |
| TOTAL | | | | | | | |
| RESIDENTIAL AREA = A+B = 1333181 + 1662734 = 2995915 sqyds | | | | | | | |
| COMMERCIAL AREA = 254832 sqyds | | | | | | | |

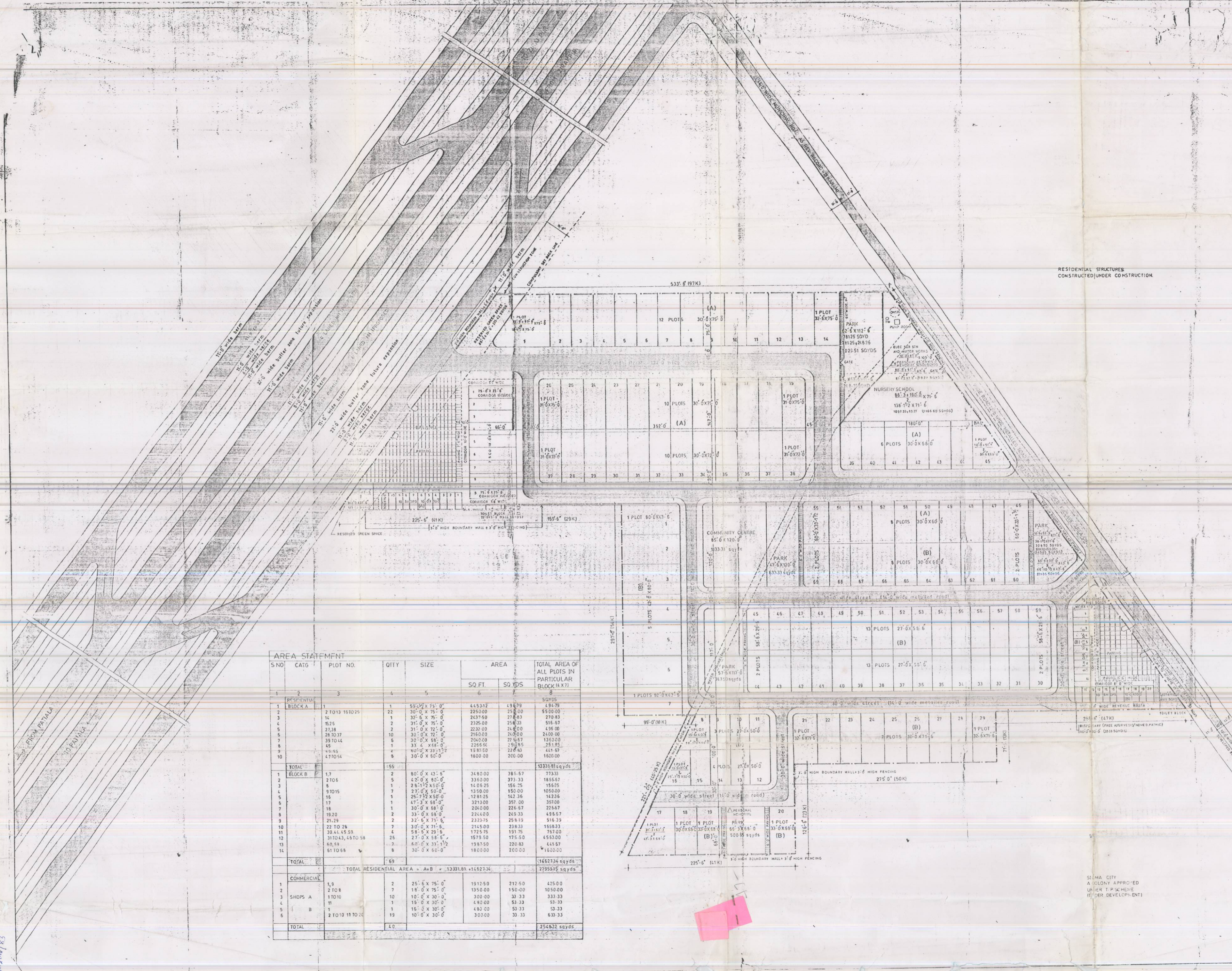

RESIDENTIAL STRUCTURES
CONSTRUCTED UNDER CONSTRUCTION

SILWA CITY
A GLOABY APPROVED
UNDER T.P. SCHEME
(FOR DEVELOPMENT)

